

In a cabin passengers, the Floor Proximity Emergency Escape Marking is intended to guide the passengers through the cabin to the exit doors in the dark of the night. Such system are defined per FAR / JAR 25.812 (e) requirements (FPEEPM).

LEDS units proposed by Madelec allow to easily built a such system adapted to the aircraft lay-out. They are available with various legend (arrows, exit, etc..), in various finish, color and power supply.

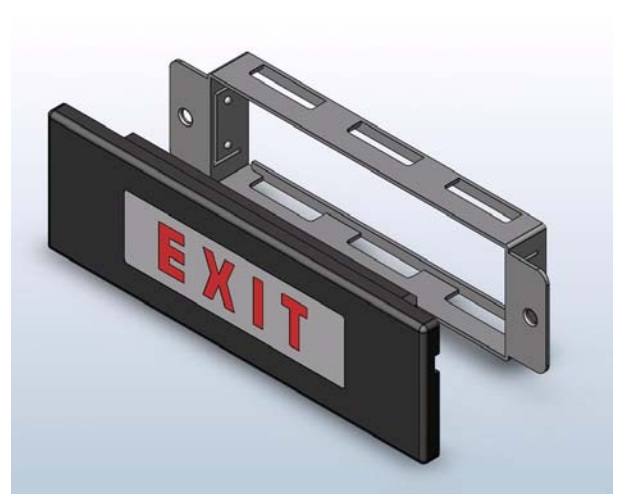
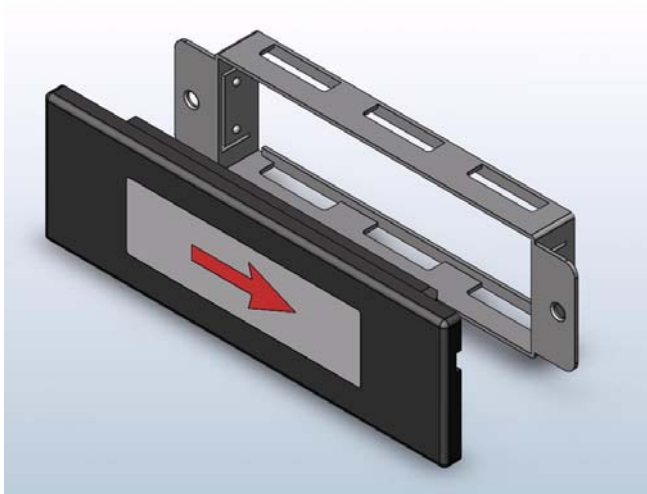

To make easier the installation and maintenance on aircraft, this unit is cogged in an dedicated mounting holder attached to the aircraft structure by two standard screws.

TECHNICAL DATA

Dimension:	120 x 38 x 12.8 mm
Mass:	0.075 kg
Power Supply:	See table
Electrical Interface:	Two TCB n°6-32 screws / 2 wires 2 m of length
Light Source:	White LED array.
Useful Life:	> 20 000 Operating Hours
Environmental Spec:	Tested & qualified according to RTCA DO160D

Dimension

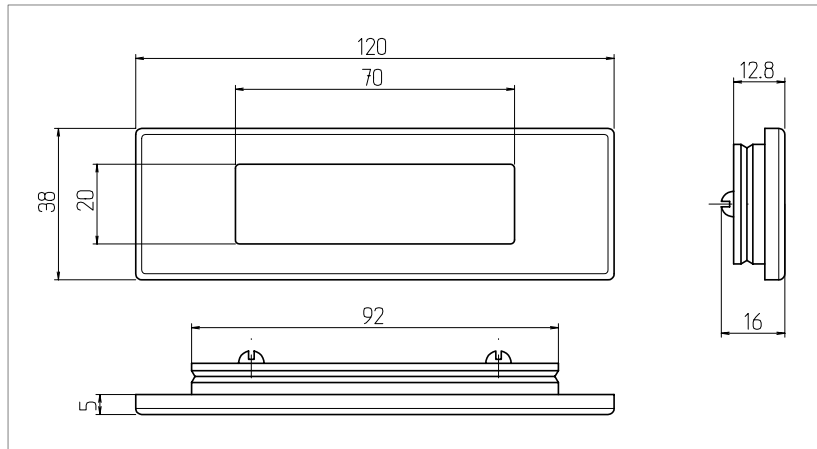

Wiring Diagram

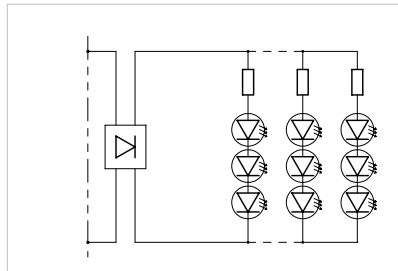

Part description numbering system

- | | | | | |
|------|------------|----------|----------|-----------------------------------|
| 533- | XXX | Y | Z | S/C |
| | ↓ | ↓ | ↓ | |
| | | | | S = Screw
C = Cable |
| | | | | Casing Finish code |
| | | | | 0 Brushing G180 + OAS uncolored |
| | | | | 1 Brushing G180 + OAS black |
| | | | | 2 Brushing G400 + OAS uncolored |
| | | | | 3 Brushing G400 + OAS black |
| | | | | 4 Nickel Brushed n° 19 (Product) |
| | | | | Power Supply code |
| | | | | A 6 VDC – 75 mA |
| | | | | B 12 VDC – 40 mA |
| | | | | D 115 VAC 400 Hz – 19 mA |
| | | | | Legend Type code |
| | | | | 010 Lighting unit |
| | | | | 011 Lighting unit with red arrows |
| | | | | 110 Vertical Exit |
| | | | | 111 Horizontal Exit |

Lighting Characteristics (P/N 533-010YZ)

Light distribution at followings measurement conditions :

- Power Supply : 6 VDC.
- Consumption : 0.075 mA
- Device installed vertically at 150 mm of the floor level.
- In the dark

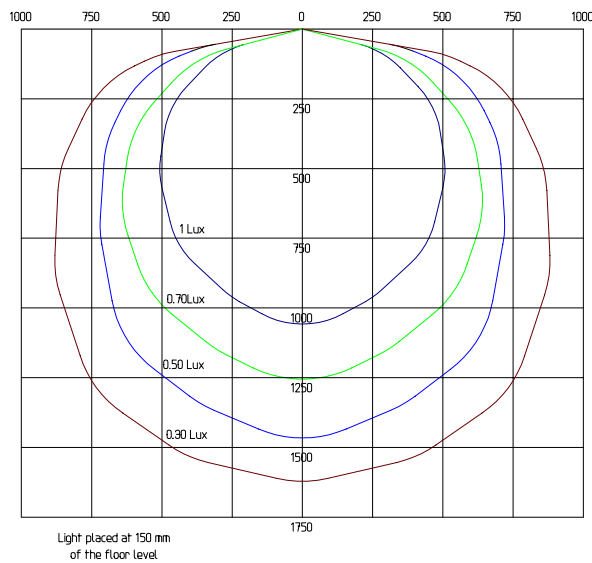

Simulation of light distribution between two light units installed at 1.75 meters apart.

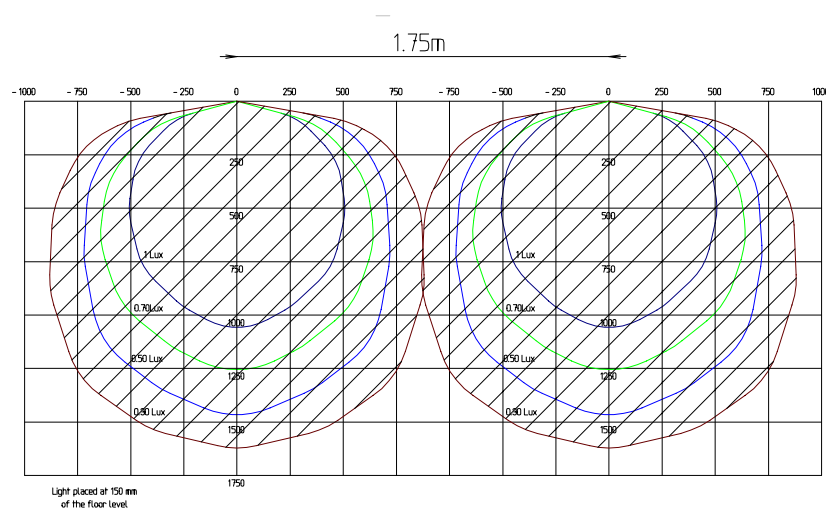

Mounting holder P/N 533-10051

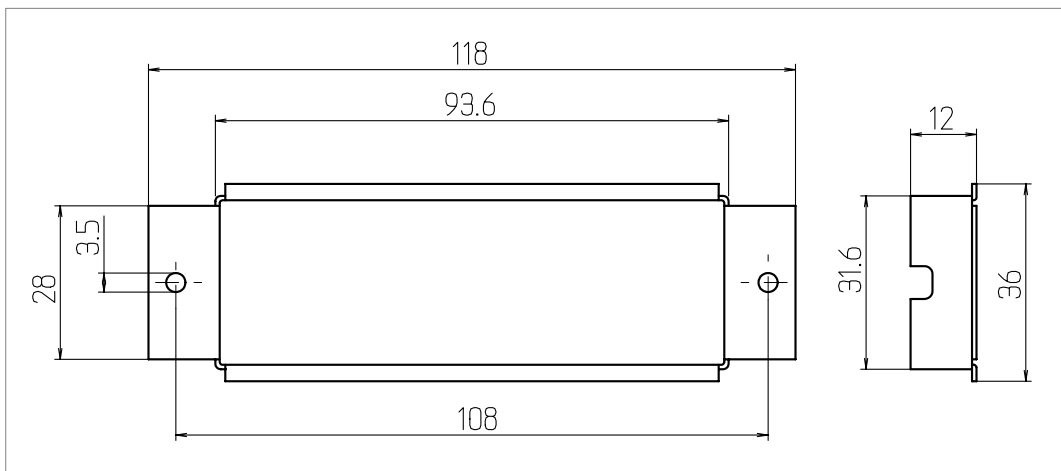

Example of installation on honeycomb panel

